



Community Planning & Permitting

2045 13th Street, Boulder, CO 80302 303-441-3930 www.bouldercounty.org

Vicinity

5762, 0 HWY 287, 14650300005

- Subject Parcel
- Municipalities
- Subdivisions**
- Subdivisions

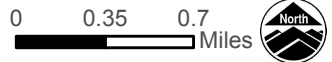
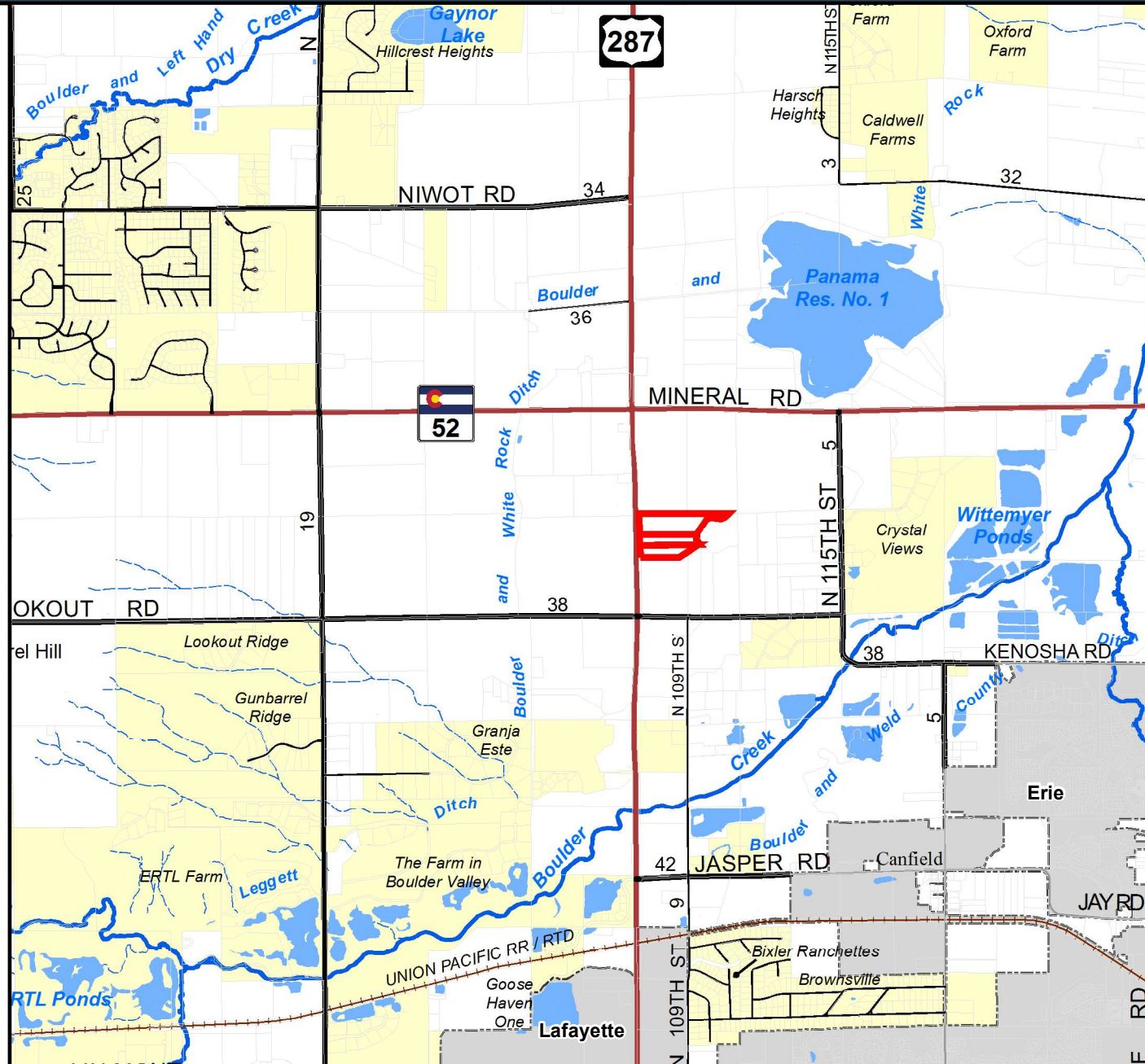

Area of Detail Date: 4/10/2020

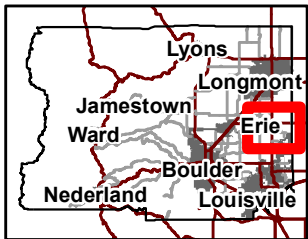

The user agrees to all Terms of Use set forth by Boulder County. For Terms of Use, please visit: www.bouldercounty.org/mapdisclaimer